

# For Lease

## Tamarack Hills F7 755 Bielenberg Drive, Woodbury, MN



### Class A Office/ Retail in Tamarack Hills, Woodbury

|                         |                   |
|-------------------------|-------------------|
| <b>Building Size:</b>   | <b>12,572 SF</b>  |
| <b>Year Built:</b>      | <b>2008</b>       |
| <b>Available Suite:</b> | <b>103</b>        |
| <b>Suite Size:</b>      | <b>1,411 sf</b>   |
| <b>Lease Rate:</b>      | <b>Negotiable</b> |
| <b>Cam:</b>             | <b>\$4.08</b>     |
| <b>Taxes:</b>           | <b>\$7.19</b>     |

- Use - retail, office & medical
- Current buildout - retail showroom
- Retail comparable off-street parking
- Easy freeway access:
  - 494 & Tamarack Road
  - 94 & Radio Drive

**Mark Young**  
Vice President, Sales and Leasing  
(D) 651-233-2435  
(M) 651-307-2371

**John Higgins**  
Vice President, Sales and Leasing  
(D) 651-209-0520  
(M) 612-702-3104

7300 Hudson Blvd., Suite 210  
Oakdale, MN 55128  
Main | 651-731-0708  
Fax | 651-735-1228  
[www.crossroadsproperties.net](http://www.crossroadsproperties.net)

**CROSSROADS  
PROPERTIES**

# Location

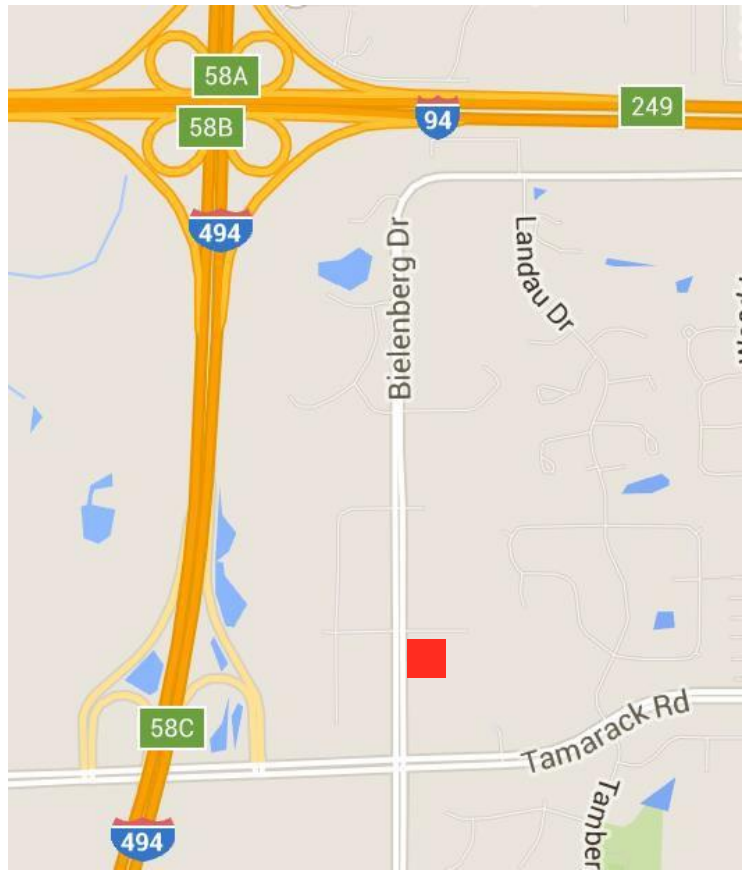

# Site Plan

